



HOMOLOGERINGSBLAD KARTING

Parilla Leopard 125

KA-H11:002

Utgåva

1

Sida

1/15

Publiceringsdatum / Giltig t.o.m.

140101 / 1612

Parilla Leopard 125

Homologeringsblad – Parilla Leopard 125



| | | | |
|---|--|-------------------|---------------|
|  | HOMOLOGERINGSBLAD KARTING | KA-H11:002 | |
| | Parilla Leopard 125 | | |
| | Error! Use the Home tab to apply Rubrik 1 to the text that you want to appear here. | | |
| | Utgåva | | 1 |
| | Sida | | 2/15 |
| | Publiceringsdatum / Giltig t.o.m. | | 140101 / 1612 |

Innehållsförteckning

| | |
|------------------------------------|----|
| Innehållsförteckning..... | 2 |
| Vy framifrån, höger sida | 3 |
| Vy bakifrån, vänster sida | 4 |
| Vy helbild..... | 5 |
| Tekniska Data | 6 |
| Mått på portar i cylinder..... | 7 |
| Cylinder..... | 8 |
| Kolv och vevparti..... | 9 |
| Kolv och reedventil | 10 |
| Förgasare Tillotson HL 334A | 11 |
| Kona/fläns insugsljuddämpare | 12 |
| Ljuddämpare | 13 |
| Koppling..... | 14 |
| Koppling 154/155/CL/06 | 15 |



| | | |
|---|--|---|
|  | HOMOLOGERINGSBLAD KARTING | KA-H11:002 1 3/15 140101 / 1612 |
| | Parilla Leopard 125 | |
| | Error! Use the Home tab to apply Rubrik 1 to the text that you want to appear here. | |
| | Utgåva | |
| | Sida | |
| Publiceringsdatum / Giltig t.o.m. | | |

Vy framifrån, höger sida

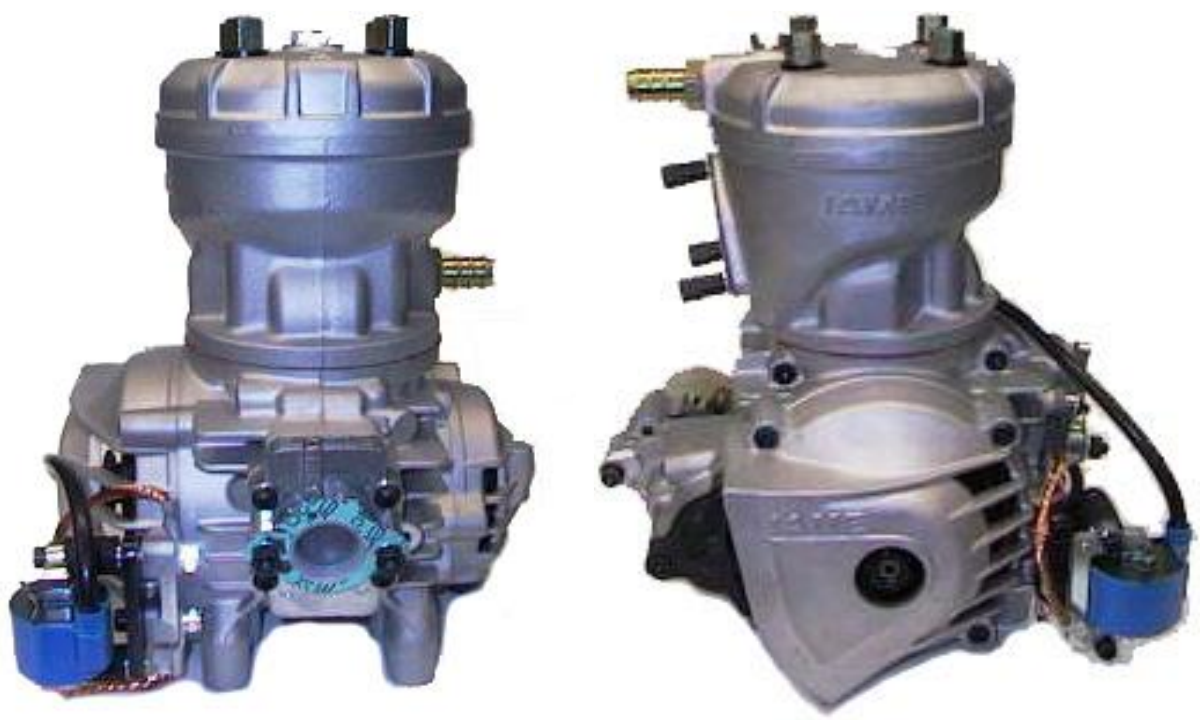

SBF Stämpel/signatur



| | | | |
|---|--|-------------------|------|
|  | HOMOLOGERINGSBLAD KARTING | KA-H11:002 | |
| | Parilla Leopard 125 | | |
| | Error! Use the Home tab to apply Rubrik 1 to the text that you want to appear here. | | |
| | Utgåva | | 1 |
| | Sida | | 4/15 |
| Publiceringsdatum / Giltig t.o.m. | 140101 / 1612 | | |

Vy bakifrån, vänster sida

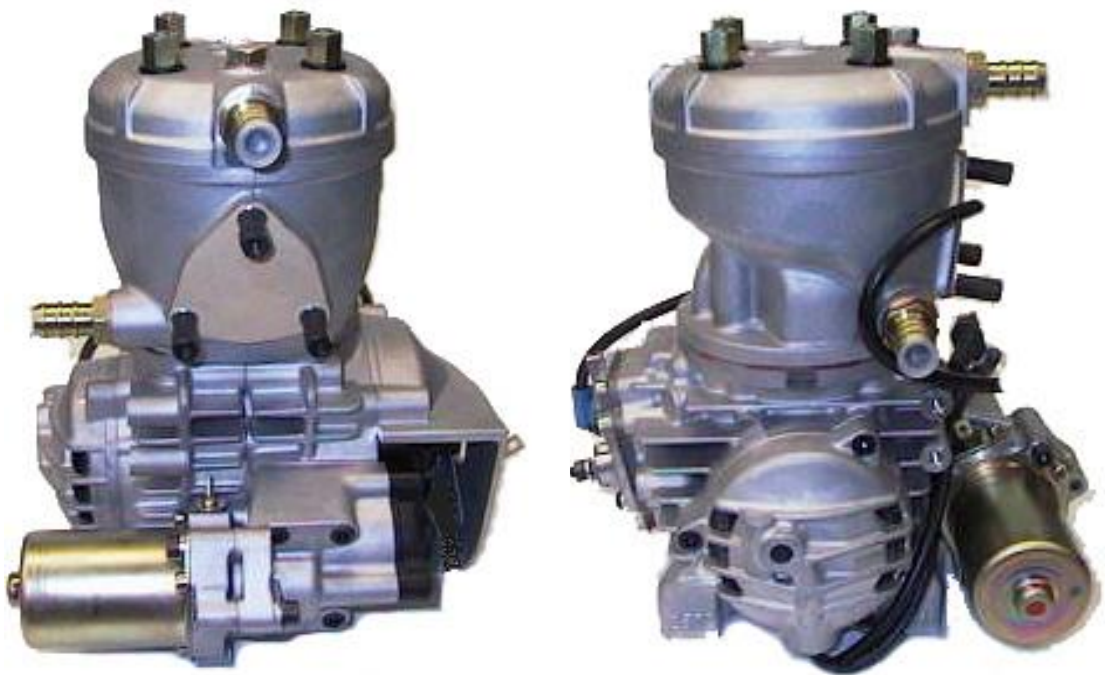

SBF Stämpel/signatur



| | | |
|---|--|---|
|  | HOMOLOGERINGSBLAD KARTING | KA-H11:002 1 5/15 140101 / 1612 |
| | Parilla Leopard 125 | |
| | Error! Use the Home tab to apply Rubrik 1 to the text that you want to appear here. | |
| | Utgåva | |
| | Sida | |
| Publiceringsdatum / Giltig t.o.m. | | |

Vy helbild



| | | |
|---|--|---|
|  | HOMOLOGERINGSBLAD KARTING | KA-H11:002 1 6/15 140101 / 1612 |
| | Parilla Leopard 125 | |
| | Error! Use the Home tab to apply Rubrik 1 to the text that you want to appear here. | |
| | Utgåva | |
| | Sida | |
| | Publiceringsdatum / Giltig t.o.m. | |

Tekniska Data

| | |
|------------------------|---|
| Cylindervolym | 125 cc max |
| Slaglängd | 54.00 mm |
| Borrning | 54.00 mm |
| Max. borrning | 54.28 mm |
| Volym förbränningsrum | 10.0 cc tolerans ± 0.5 cc |
| Mätmetod | Med insats, enligt CIK:s mätmetod |
| Överströmningskanaler | 3 st |
| Förgasare | Tillotson HL 334A alt. CIK homologerad (homlogeringsperiod 2001 - 2003, 2004 -) |
| Venturi | Max 24.00 mm |
| Tändsystem | PVL alt. Selletra |
| Vevstakslängd | 102 mm |
| Material cylinderfoder | Gjutjärn |
| Kylmedium | Vatten |

ÖPPNINGSTIDER

| | |
|--------------------|-----------------------------|
| Avgasport | 170° max |
| Insug | Reedventil |
| Överströmningsport | 123° tolerans $\pm 2^\circ$ |
| TT port | 126° tolerans $\pm 2^\circ$ |

| Dimensioner | < 25 mm | 25 - 60 mm | > 60 mm |
|---------------|--------------|--------------|--------------|
| Beräddad yta | ± 0.5 mm | ± 0.8 mm | ± 1.5 mm |
| Oberäddad yta | ± 1.0 mm | ± 1.5 mm | ± 3.0 mm |

TRIMNING

Ingen trimning tillåten, all bearbetning förbjuden





HOMOLOGERINGSBLAD KARTING

Parilla Leopard 125

Error! Use the Home tab to apply Rubrik 1 to the text that you want to appear here.

Utgåva

Sida

Publiceringsdatum / Giltig t.o.m.

KA-H11:002

1

7/15

140101 / 1612

Mått på portar i cylinder

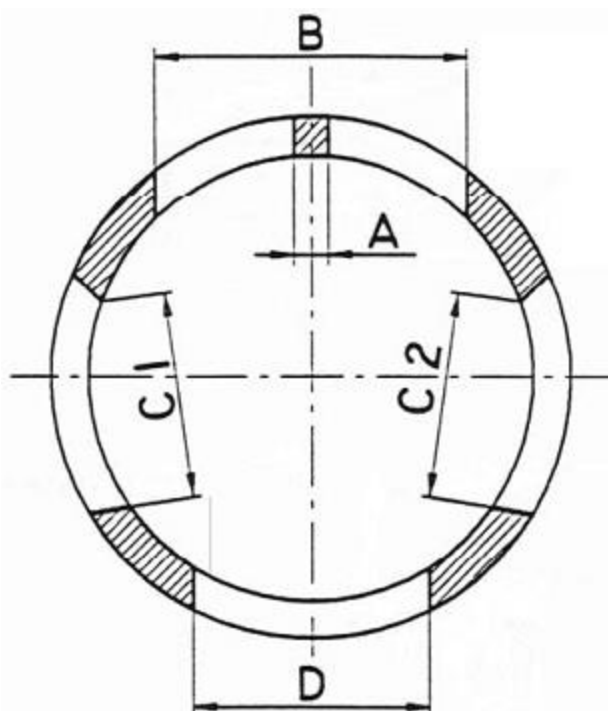

| | |
|---------|----------------------|
| A | $\geq 4 \text{ mm}$ |
| B | $\leq 50 \text{ mm}$ |
| C1 = C2 | $\leq 27 \text{ mm}$ |
| D | $\leq 29 \text{ mm}$ |

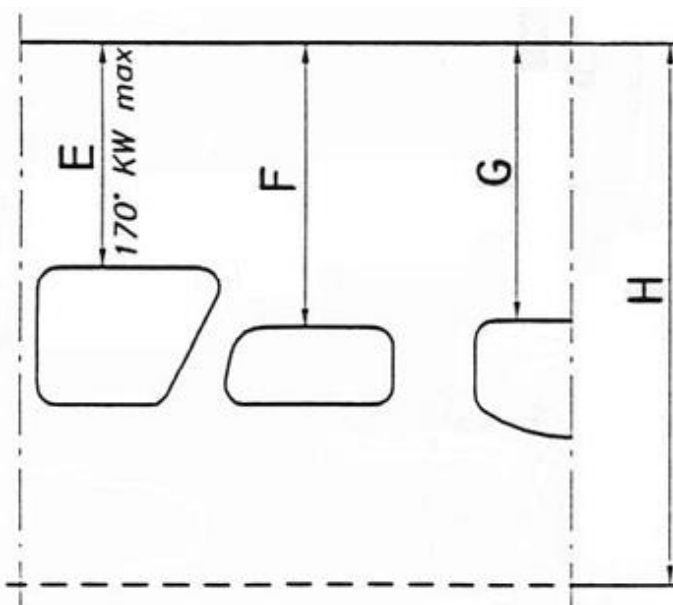

| | |
|---|-------------------------|
| E | 170° max |
| F | $123^\circ \pm 2^\circ$ |
| G | $126^\circ \pm 2^\circ$ |





HOMOLOGERINGSBLAD KARTING

Parilla Leopard 125

Error! Use the Home tab to apply Rubrik 1 to the text that you want to appear here.

Utgåva

Sida

Publiceringsdatum / Giltig t.o.m.

KA-H11:002

1

8/15

140101 / 1612

Cylinder

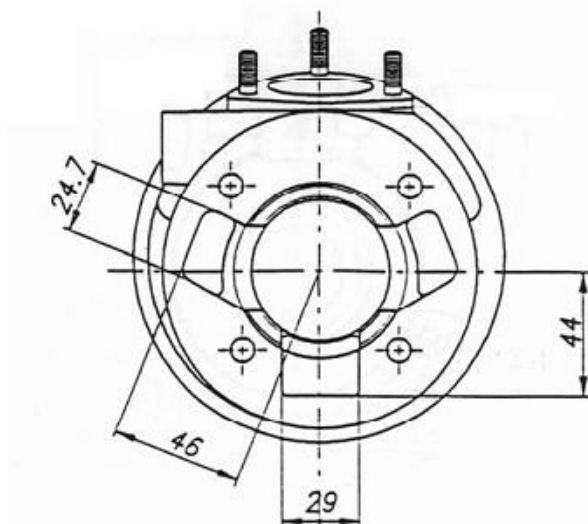
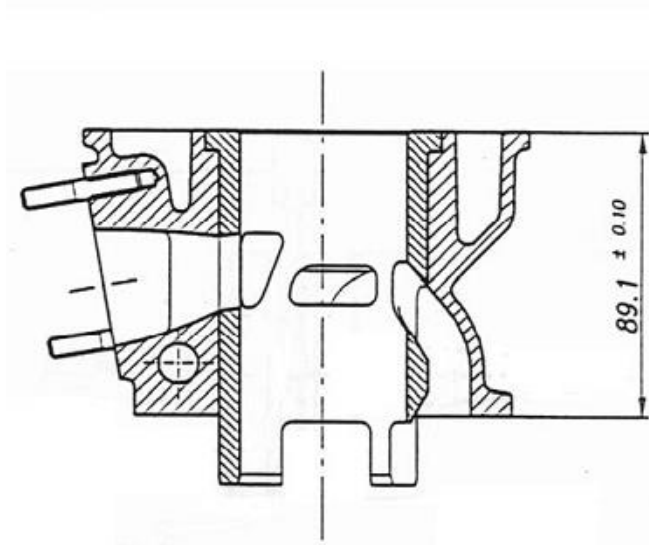
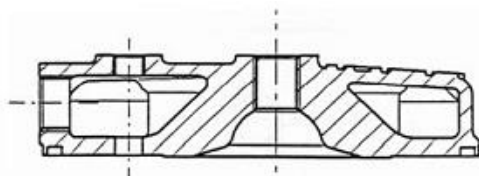

| | | |
|---|--|---|
|  | HOMOLOGERINGSBLAD KARTING | KA-H11:002 1 9/15 140101 / 1612 |
| | Parilla Leopard 125 | |
| | Error! Use the Home tab to apply Rubrik 1 to the text that you want to appear here. | |
| | Utgåva | |
| | Sida | |
| Publiceringsdatum / Giltig t.o.m. | | |

Kolv och vevparti

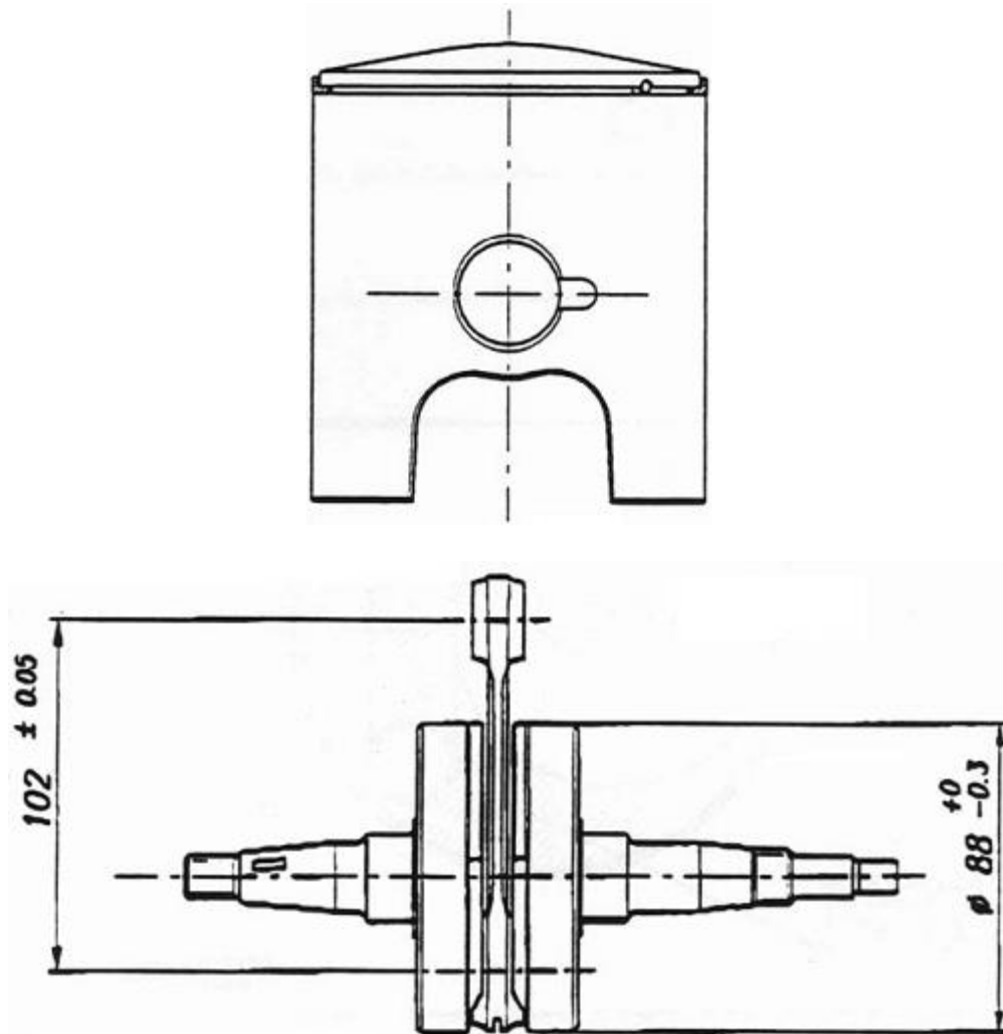

| | | |
|---|--|--|
|  | HOMOLOGERINGSBLAD KARTING | KA-H11:002 1 10/15 140101 / 1612 |
| | Parilla Leopard 125 | |
| | Error! Use the Home tab to apply Rubrik 1 to the text that you want to appear here. | |
| | Utgåva | |
| | Sida | |
| Publiceringsdatum / Giltig t.o.m. | | |

Kolv och reedventil



| |
|--|
| SBF Stämpel/signatur   |
|--|

| | | |
|---|--|--|
|  | HOMOLOGERINGSBLAD KARTING | KA-H11:002 1 11/15 140101 / 1612 |
| | Parilla Leopard 125 | |
| | Error! Use the Home tab to apply Rubrik 1 to the text that you want to appear here. | |
| | Utgåva | |
| | Sida | |
| Publiceringsdatum / Giltig t.o.m. | | |

Förgasare Tillotson HL 334A

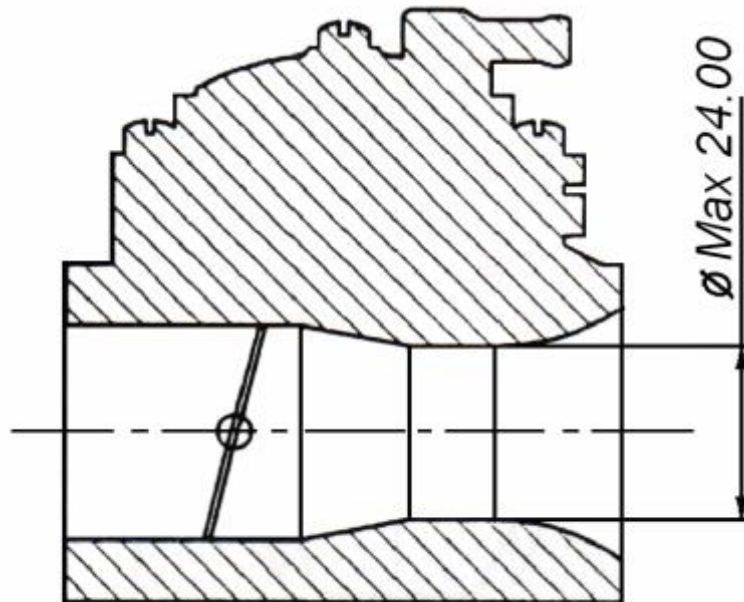



HOMOLOGERINGSBLAD KARTING

Parilla Leopard 125

Error! Use the Home tab to apply Rubrik 1 to the text that you want to appear here.

Utgåva

Sida

Publiceringsdatum / Giltig t.o.m.

KA-H11:002

1

12/15

140101 / 1612

Kona/fläns insugsjuddämpare

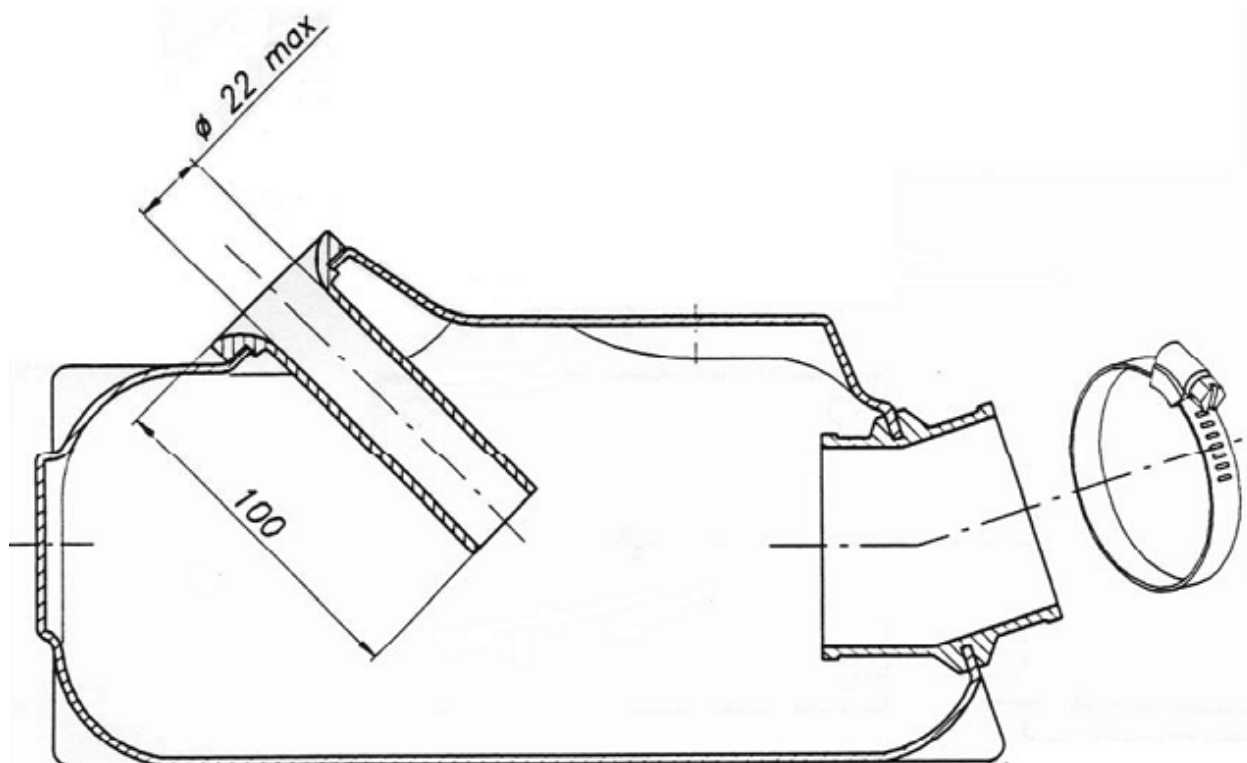
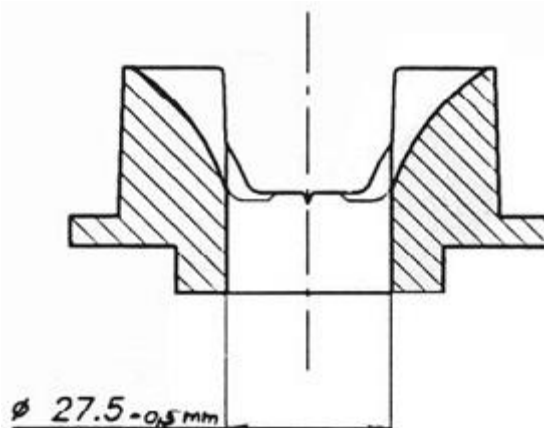



HOMOLOGERINGSBLAD KARTING

Parilla Leopard 125

Error! Use the Home tab to apply Rubrik 1 to the text that you want to appear here.

Utgåva

Sida

Publiceringsdatum / Giltig t.o.m.

KA-H11:002

1

13/15

140101 / 1612

Ljuddämpare

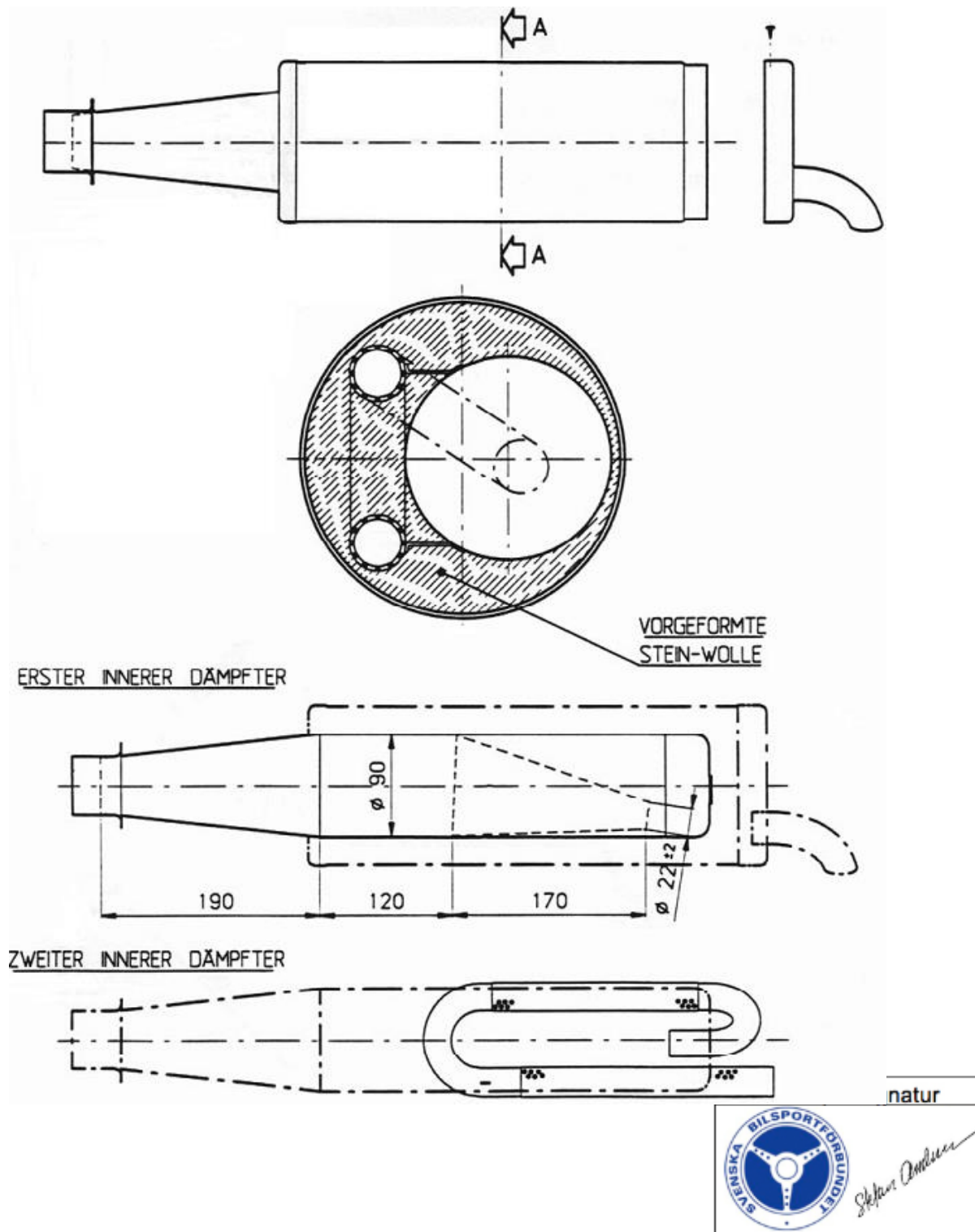



HOMOLOGERINGSBLAD KARTING

Parilla Leopard 125

Error! Use the Home tab to apply Rubrik 1 to the text that you want to appear here.

Utgåva

Sida

Publiceringsdatum / Giltig t.o.m.

KA-H11:002

1

14/15

140101 / 1612

Koppling

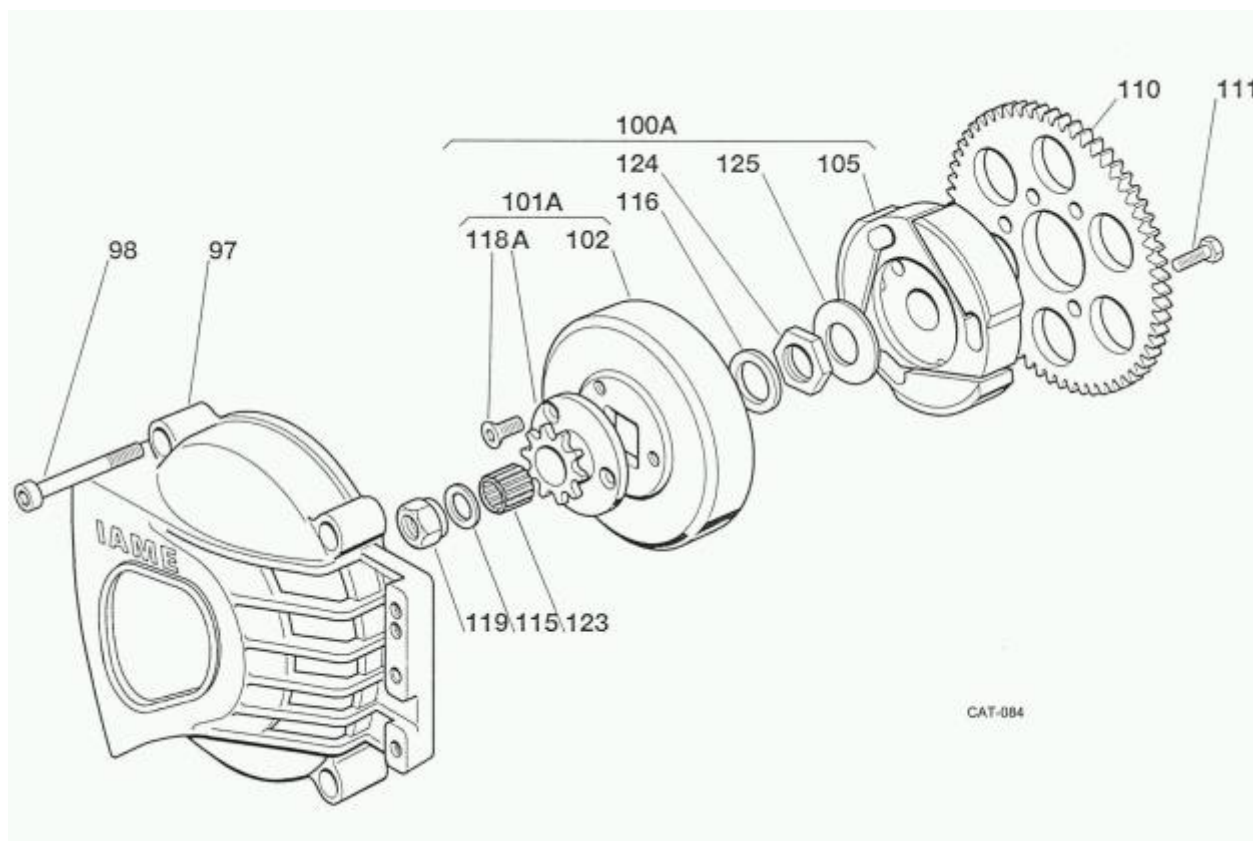



HOMOLOGERINGSBLAD KARTING

Parilla Leopard 125

Error! Use the Home tab to apply Rubrik 1 to the text that you want to appear here.

Utgåva

Sida

Publiceringsdatum / Giltig t.o.m.

KA-H11:002

1

15/15

140101 / 1612

Koppling 154/155/CL/06

- 9 -

No. d'homologation FIA/CIK: 154/M/06

| DESCRIPTION DE L'EMBRAYAGE ET ESQUISSE DES PIÈCES | CLUTCH DESCRIPTION AND SCETCH OF PARTS | | | | | | | | | | | | | | | | | | | | | | | | | | | | | | | | | | | | | | | | | | | | | | | | | | | |
|---|--|------------------------|------------|----------------|---|-----|-------------------|---|--------|-----------------------------|---|--------------------|------------------------------|---|------------------------|-------------------|---|--------|----------------|---|-----|-------------------|---|--------|--------------|---|-------|----------------------|---|-------------|----------------------------|---|---------------|-----------------------------|---|----------------|----------------------------|---|-----------|-------------------|---|--------|-----------------|---|----------|---------------|---|-----|-----------------|----|-------|--|
| Marque/Make: <u>PARILLA / HORSTMAN</u> Type/Typ: <u>EXPD III</u> CIK Nr.: <u>154/155/CL/06</u> | | | | | | | | | | | | | | | | | | | | | | | | | | | | | | | | | | | | | | | | | | | | | | | | | | | | |
| | | | | | | | | | | | | | | | | | | | | | | | | | | | | | | | | | | | | | | | | | | | | | | | | | | | | |
| <table border="1" style="width: 100%; border-collapse: collapse;"> <thead> <tr> <th>ELEMENTS</th> <th>QUANTITE / QUANTITY</th> <th>COMPONENTS</th> </tr> </thead> <tbody> <tr><td>Fig. 1 - Ecrou</td><td style="text-align: center;">1</td><td>Nut</td></tr> <tr><td>Fig. 2 - Rondelle</td><td style="text-align: center;">1</td><td>Washer</td></tr> <tr><td>Fig. 3 - Guide ou roulement</td><td style="text-align: center;">1</td><td>Bushing or bearing</td></tr> <tr><td>Fig. 4 - Calotte avec pignon</td><td style="text-align: center;">1</td><td>Sprocket drum assembly</td></tr> <tr><td>Fig. 5 - Rondelle</td><td style="text-align: center;">1</td><td>Washer</td></tr> <tr><td>Fig. 6 - Ecrou</td><td style="text-align: center;">1</td><td>Nut</td></tr> <tr><td>Fig. 7 - Rondelle</td><td style="text-align: center;">1</td><td>Washer</td></tr> <tr><td>Fig. 8 - Vis</td><td style="text-align: center;">3</td><td>Screw</td></tr> <tr><td>Fig. 9 - Disque fixe</td><td style="text-align: center;">1</td><td>Fixed plate</td></tr> <tr><td>Fig. 10 - Disque embrayage</td><td style="text-align: center;">1</td><td>Friction disc</td></tr> <tr><td>Fig. 11 - Disque à pression</td><td style="text-align: center;">1</td><td>Pressure plate</td></tr> <tr><td>Fig. 12 - Moyeu entraîneur</td><td style="text-align: center;">1</td><td>Drive hub</td></tr> <tr><td>Fig. 13 - Ressort</td><td style="text-align: center;">3</td><td>Spring</td></tr> <tr><td>Fig. 14 - Guide</td><td style="text-align: center;">3</td><td>Retainer</td></tr> <tr><td>Fig. 15 - Axe</td><td style="text-align: center;">3</td><td>Pin</td></tr> <tr><td>Fig. 16 - Masse</td><td style="text-align: center;">15</td><td>Lever</td></tr> </tbody> </table> | ELEMENTS | QUANTITE / QUANTITY | COMPONENTS | Fig. 1 - Ecrou | 1 | Nut | Fig. 2 - Rondelle | 1 | Washer | Fig. 3 - Guide ou roulement | 1 | Bushing or bearing | Fig. 4 - Calotte avec pignon | 1 | Sprocket drum assembly | Fig. 5 - Rondelle | 1 | Washer | Fig. 6 - Ecrou | 1 | Nut | Fig. 7 - Rondelle | 1 | Washer | Fig. 8 - Vis | 3 | Screw | Fig. 9 - Disque fixe | 1 | Fixed plate | Fig. 10 - Disque embrayage | 1 | Friction disc | Fig. 11 - Disque à pression | 1 | Pressure plate | Fig. 12 - Moyeu entraîneur | 1 | Drive hub | Fig. 13 - Ressort | 3 | Spring | Fig. 14 - Guide | 3 | Retainer | Fig. 15 - Axe | 3 | Pin | Fig. 16 - Masse | 15 | Lever | |
| ELEMENTS | QUANTITE / QUANTITY | COMPONENTS | | | | | | | | | | | | | | | | | | | | | | | | | | | | | | | | | | | | | | | | | | | | | | | | | | |
| Fig. 1 - Ecrou | 1 | Nut | | | | | | | | | | | | | | | | | | | | | | | | | | | | | | | | | | | | | | | | | | | | | | | | | | |
| Fig. 2 - Rondelle | 1 | Washer | | | | | | | | | | | | | | | | | | | | | | | | | | | | | | | | | | | | | | | | | | | | | | | | | | |
| Fig. 3 - Guide ou roulement | 1 | Bushing or bearing | | | | | | | | | | | | | | | | | | | | | | | | | | | | | | | | | | | | | | | | | | | | | | | | | | |
| Fig. 4 - Calotte avec pignon | 1 | Sprocket drum assembly | | | | | | | | | | | | | | | | | | | | | | | | | | | | | | | | | | | | | | | | | | | | | | | | | | |
| Fig. 5 - Rondelle | 1 | Washer | | | | | | | | | | | | | | | | | | | | | | | | | | | | | | | | | | | | | | | | | | | | | | | | | | |
| Fig. 6 - Ecrou | 1 | Nut | | | | | | | | | | | | | | | | | | | | | | | | | | | | | | | | | | | | | | | | | | | | | | | | | | |
| Fig. 7 - Rondelle | 1 | Washer | | | | | | | | | | | | | | | | | | | | | | | | | | | | | | | | | | | | | | | | | | | | | | | | | | |
| Fig. 8 - Vis | 3 | Screw | | | | | | | | | | | | | | | | | | | | | | | | | | | | | | | | | | | | | | | | | | | | | | | | | | |
| Fig. 9 - Disque fixe | 1 | Fixed plate | | | | | | | | | | | | | | | | | | | | | | | | | | | | | | | | | | | | | | | | | | | | | | | | | | |
| Fig. 10 - Disque embrayage | 1 | Friction disc | | | | | | | | | | | | | | | | | | | | | | | | | | | | | | | | | | | | | | | | | | | | | | | | | | |
| Fig. 11 - Disque à pression | 1 | Pressure plate | | | | | | | | | | | | | | | | | | | | | | | | | | | | | | | | | | | | | | | | | | | | | | | | | | |
| Fig. 12 - Moyeu entraîneur | 1 | Drive hub | | | | | | | | | | | | | | | | | | | | | | | | | | | | | | | | | | | | | | | | | | | | | | | | | | |
| Fig. 13 - Ressort | 3 | Spring | | | | | | | | | | | | | | | | | | | | | | | | | | | | | | | | | | | | | | | | | | | | | | | | | | |
| Fig. 14 - Guide | 3 | Retainer | | | | | | | | | | | | | | | | | | | | | | | | | | | | | | | | | | | | | | | | | | | | | | | | | | |
| Fig. 15 - Axe | 3 | Pin | | | | | | | | | | | | | | | | | | | | | | | | | | | | | | | | | | | | | | | | | | | | | | | | | | |
| Fig. 16 - Masse | 15 | Lever | | | | | | | | | | | | | | | | | | | | | | | | | | | | | | | | | | | | | | | | | | | | | | | | | | |
| <p>L'embrayage doit obligatoirement engager le moteur au maximum à 6000 t/m.</p> <p>Il est absolument interdit de modifier les pièces composant le groupe embrayage. Les pièces doivent toujours correspondre au type du groupe embrayage vérifié et plombé à l'homologation.</p> <p>The clutch must operating on the engine at a maximum of 6000 t/min.</p> <p>It is absolutely forbidden to modify the components which are composing the entire clutch, checked and sealed at the homologation.</p> | | | | | | | | | | | | | | | | | | | | | | | | | | | | | | | | | | | | | | | | | | | | | | | | | | | | |

Stämpel/signatur

